

Planimetria di Progetto
Scala 1:200

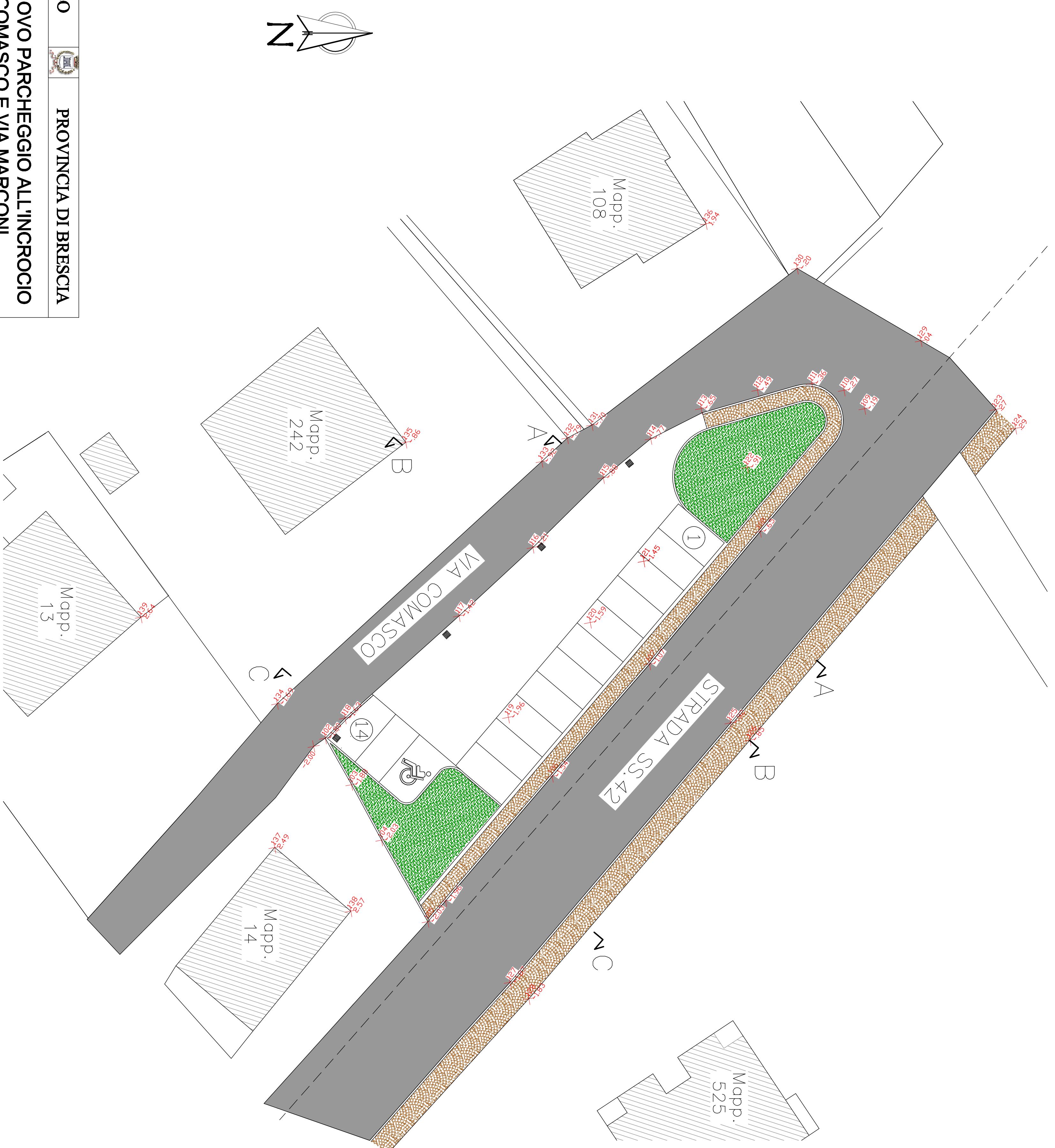

Sezione A-A
Scala 1.100

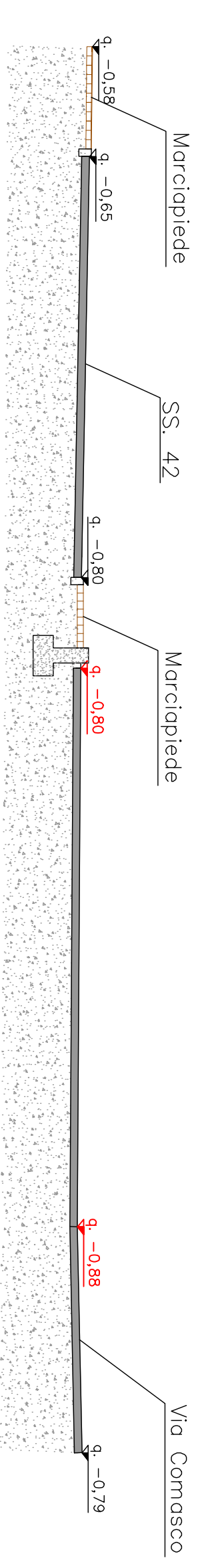

Sezione B-B
Scala 1.100

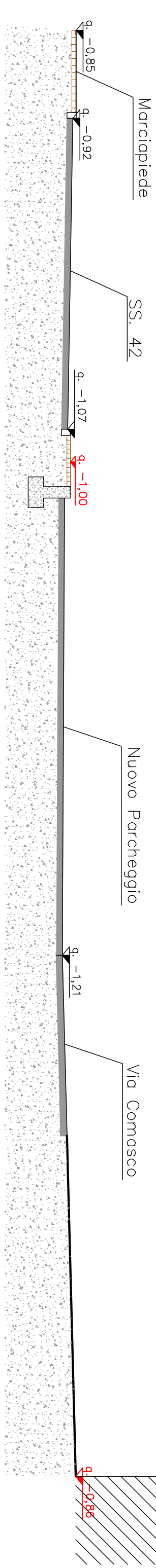

Sezione C-C
Scala 1.100

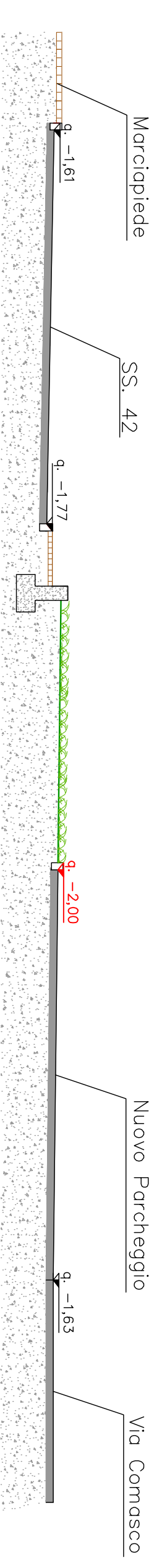

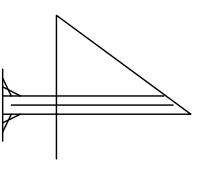
<p>COMUNE DI EDOLO</p>  <p>PROVINCIA DI BRESCIA</p>	<p>FORMAZIONE NUOVO PARCHEGGIO ALL'INCROCIO TRA VIA COMASCO E VIA MARCONI</p> <p>PROGETTO PRELIMINARE</p> <p>OGGETTO: PLANIMETRIA DI PROGETTO E SEZIONI.</p>
<p>Il progettista: GARI spem. LORENZO STUDIO TECNICO - Via O. Sava n. 22 - 25046 EDOLO (BS) Tel. 030/6771818 - Cell. 320/6771818 - Email: info@studiogari.it</p>	<p>Fondale</p>
<p>Autore:</p> 	<p>Scala:</p> 